

BR5100 Assembly w/Options

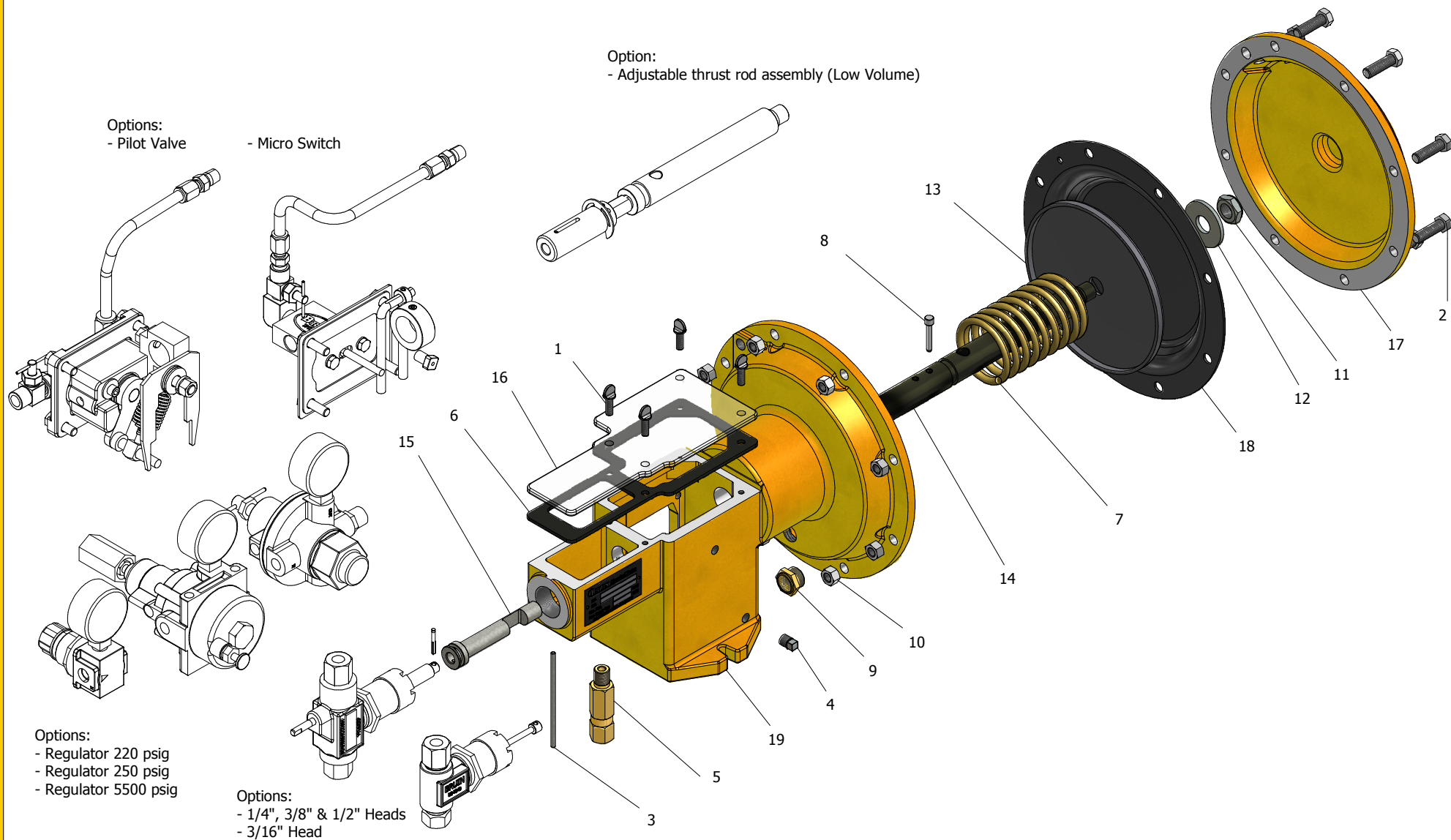

BR5100 ASSEMBLY

ITEM	QTY	TITLE	MATERIAL	STOCK NUMBER
1	4	WING SCREW	Steel Plated	BA-0136
2	8	HEX HEAD CAPSCREW	Carbon Steel Plated	BA-0139
3	1	GLAND WRENCH	Carbon Steel Plated	BA-0315
4	1	PIPE PLUG	Carbon Steel Plated	BA-0516
5	1	CHECK VALVE 1/4"	Brass	BA-0676
°	1	CHECK VALVE 1/4"	Stainless Steel	BA-0675
6 r	1	COVER GASKET - 5100	Buna N	BA-1546A
7 r	1	MAIN RETURN SPRING	Steel Plated	BA-1821
°	1	MAIN RETURN SPRING - LOW SUPPLY PRESSURE	Steel	BA-1821LP
8	1	ADJUSTING PIN	Stainless Steel	BA-1828
9	1	AIR VENT	Brass	BA-1835
10	8	HEX NUT	Carbon Steel Plated	BA-2207
11	1	HEX LOCK NUT	Carbon Steel Plated	BA-3320
12	1	WASHER	Carbon Steel Plated	BA-3321
13	1	DIAPHRAGM PLATE - SKIRTED	Carbon Steel	BB-0438A
14	1	THRUST ROD	Stainless Steel	BB-0444
15	1	ADAPTER	Carbon Steel Plated	BB-0447
16	1	COVER	Clear Transparent	BB-0548A
17	1	DIAPHRAGM COVER 5100	Cast Iron	BC-0252
18 r	1	MOLDED DIAPHRAGM	Nitrile-Nylon Fabric	BC-0290
19	1	HOUSING BR5100	Cast Iron	BD-0251
°		Options		
r		Recommended Spare Parts		

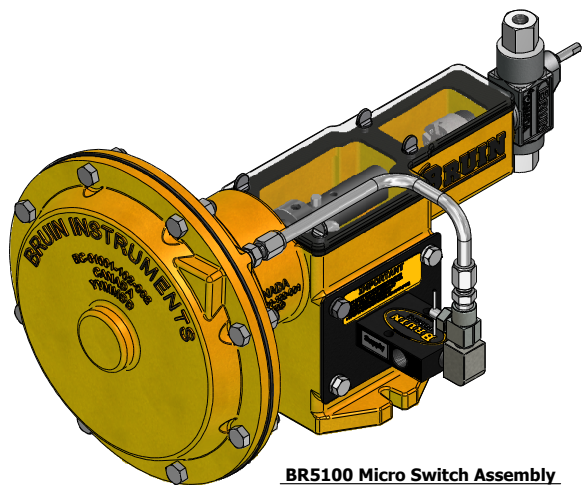

BR5100 Micro Switch Assembly

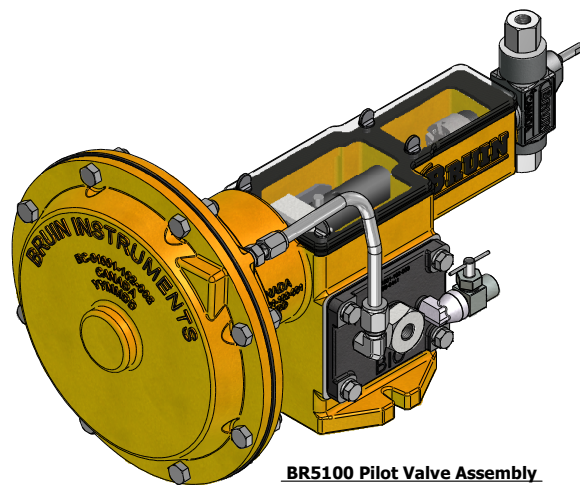

BR5100 Pilot Valve Assembly